

## COVID-19 Map Layout - Downstairs

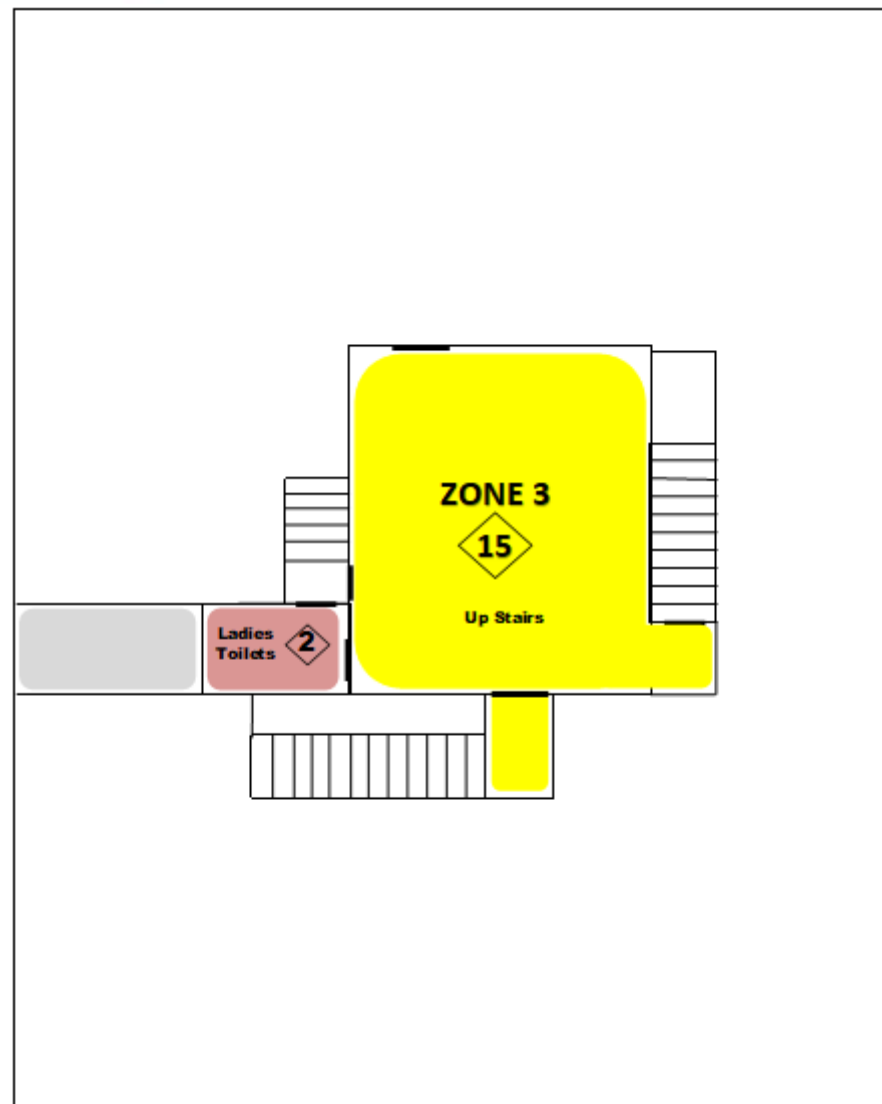

## COVID-19 Map Layout - Upstairs

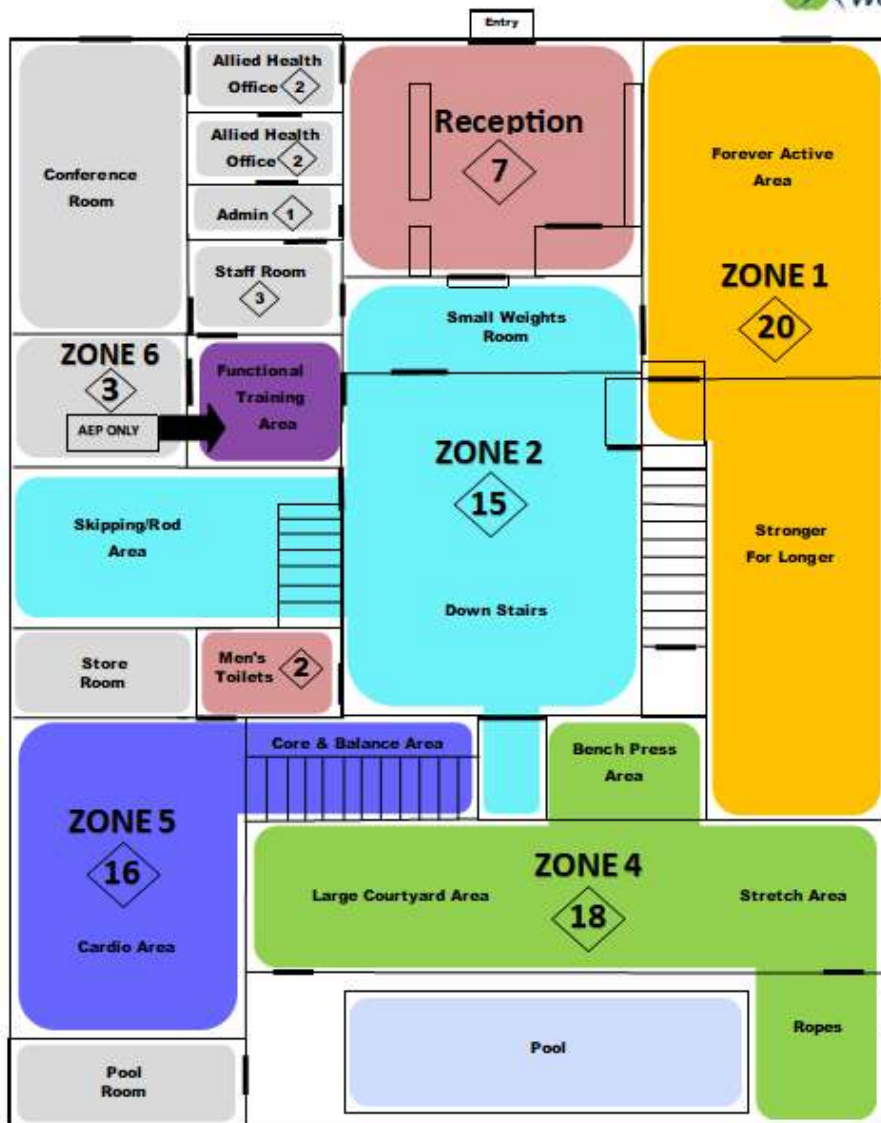

### What to bring with you

- 1 Two Towels (to ensure the equipment is fully covered)
- 2 Own Pencil
- 3 Own Water Bottle
- 4 Own Hand Sanitiser (also supplied in Centre in general use bottles)
- 5 Small Bag (As we can't keep anything at Reception-you need to carry with you)

### What do you need to do while in Green Apple

- 1 Comply to the MAXIMUM Number of people allowed in each area (required for COVID Compliance)
- 2 Wiping of all equipment that you have contact with wipes supplied
- 3 Social Distancing at ALL TIMES of 1.5 sq. metres
- 4 Wash hands or used hand sanitiser regularly
- 5 Wear gloves (optional supplied at Reception)

### What can be used/not used

- 1 Toilets can be used but need to wash hands beforehand and afterwards (Cleaning by staff will be each hour)
- 2 No Showers
- 3 No Water Fountains—MUST bring your own water
- 4 Use equipment and be mindful of other members need of that equipment